



PARENT PICK UP & DROP OFF TRAFFIC FLOW 2023 - 2024 SCHOOL YEAR

PARKING NOTICE:

- Back lot is reserved for faculty /staff.
- East lot reserved for school bus and faculty/staff parking only.
- No student drop off and no parent/student parking in the East lot.

DROP OFF / PICK UP ZONES:

- MS/US students - drop off/pick up along the sidewalk in front of the MS and PAC.
- Pull forward to the Performing Arts Center or as far as possible before allowing students to exit the car.
- LS students may be dropped off along the sidewalk in the circle.
- LS students may be picked up along the sidewalk in the circle or along the front of LS.
- Pull forward as far as possible before allowing students to exit/enter the car.
- Students need to be ready to exit the car when you enter the drop off zone.
- Students should only exit car on the passenger side.
- Adults should not exit the car in the drop-off/pick up zone. Park in the lot if needed.

ENTRY / EXIT NOTICE:

- MS/US students may only enter/exit the school through the main doors located at the front of the school.
- LS students will enter/exit the school through Door 25 located on the East side of the building.
- LS students may also enter/exit the school through the main doors if escorted by an adult or MS/US sibling.
- Students may not enter or exit the building from any back doors before, during or immediately after school.

***Please pack your patience
and drive slowly!***

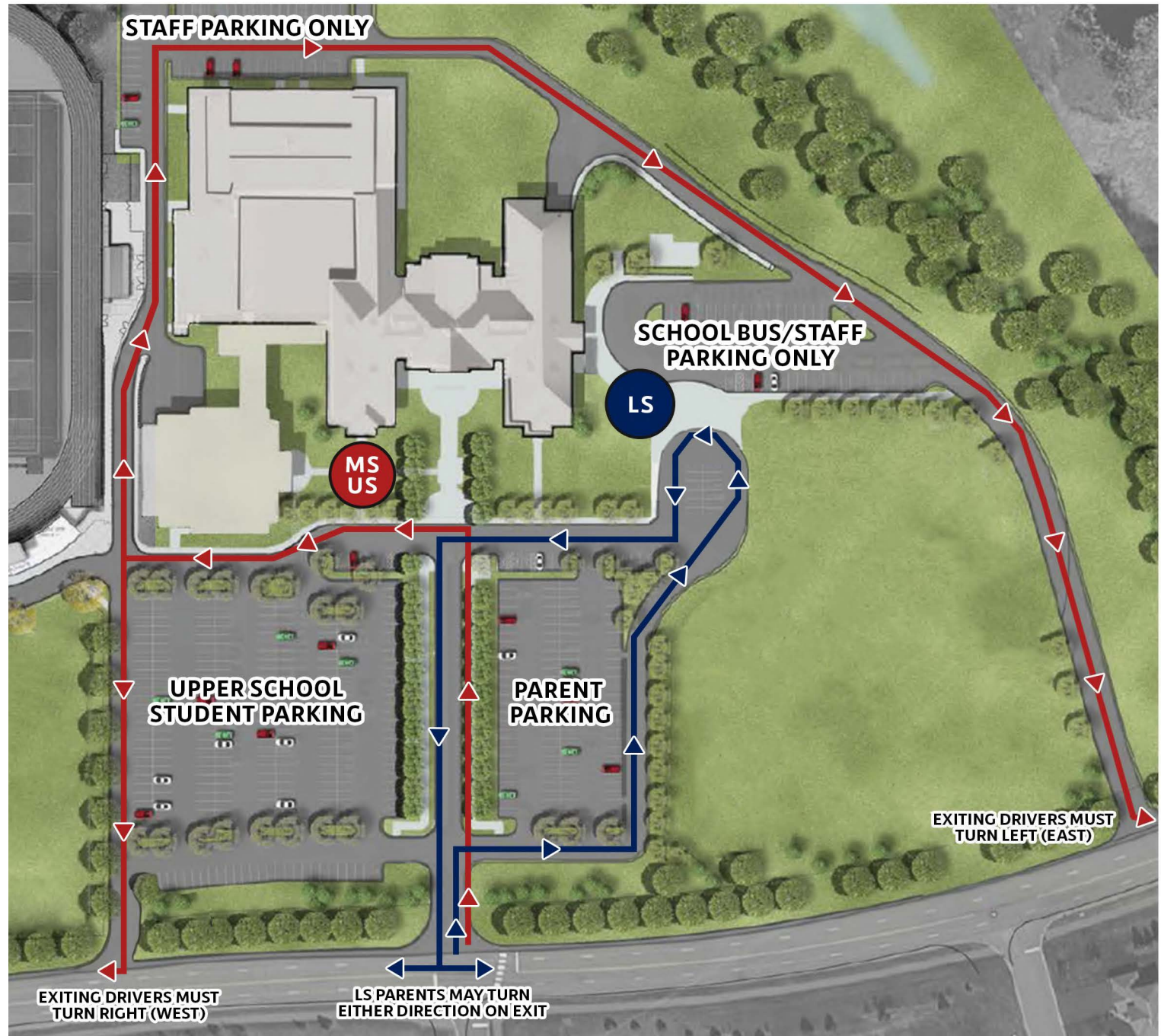

STUDENT ARRIVAL & DEPARTURE TRAFFIC FLOW

2023 - 2024 SCHOOL YEAR

PARKING NOTICE:

- Back lot is reserved for faculty / staff.
- East lot reserved for school bus and faculty/staff parking only.
- No student drop off and no parent/student parking in the East lot.

ENTRY / EXIT NOTICE:

- MS/US students may only enter/exit the school through the main doors located at the front of the school.
- LS students may also enter/exit the school through the main doors if escorted by an adult or MS/US sibling.
- Students may not enter/exit the building from any back doors before, during or immediately after school.

Please pack your patience and drive slowly!

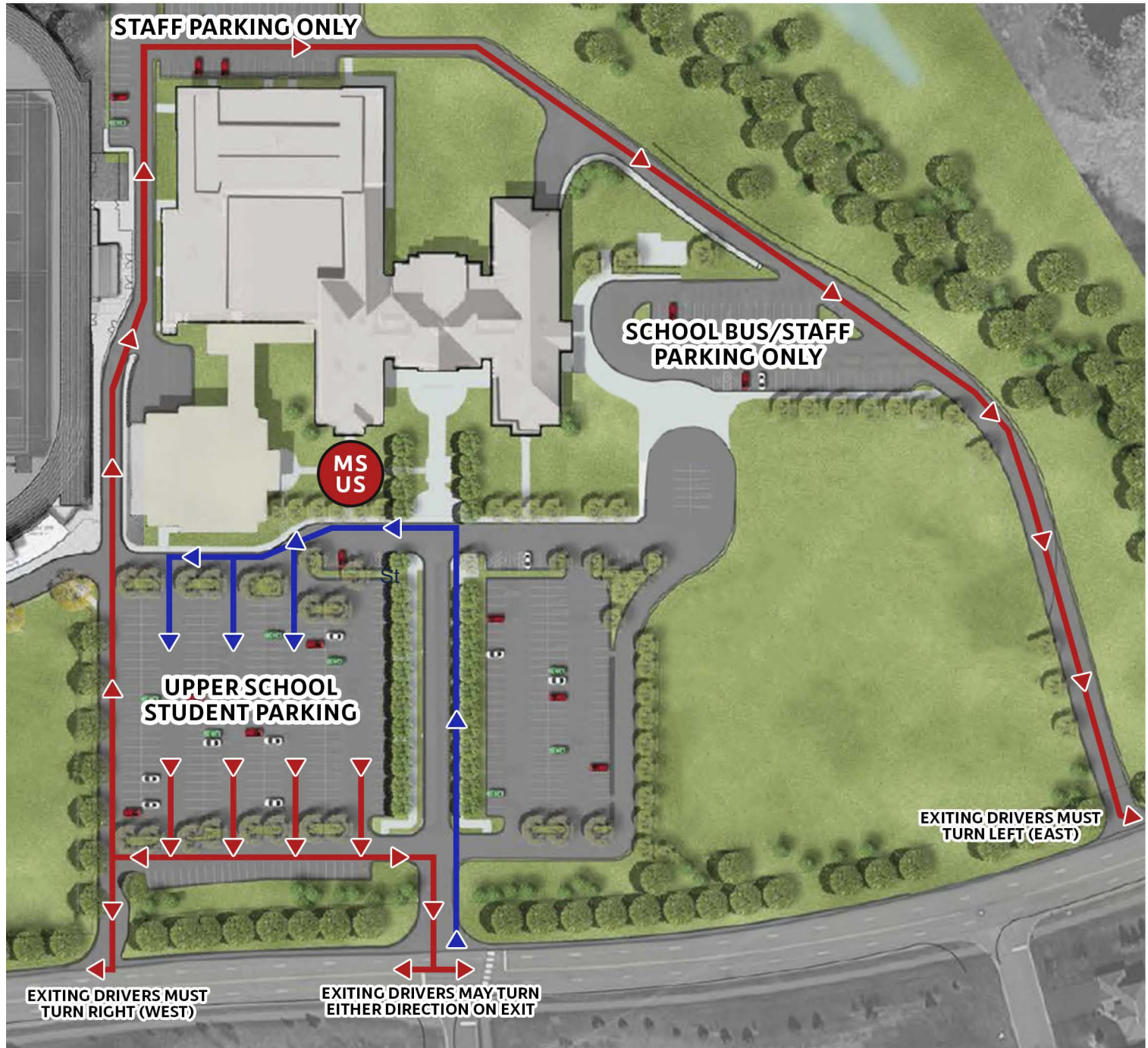

P
Par
sch
and
park
in th
The
rese
facu
and
be p